Women in MacArthur Park: An Inclusive Plan Booklet

Melanie & Samara

EA 135 | Spring 2026

March 2026

01 Chapter 1
Existing Conditions and Analysis



02 Chapter 2
Community Narratives



03 Chapter 3
Looking ahead

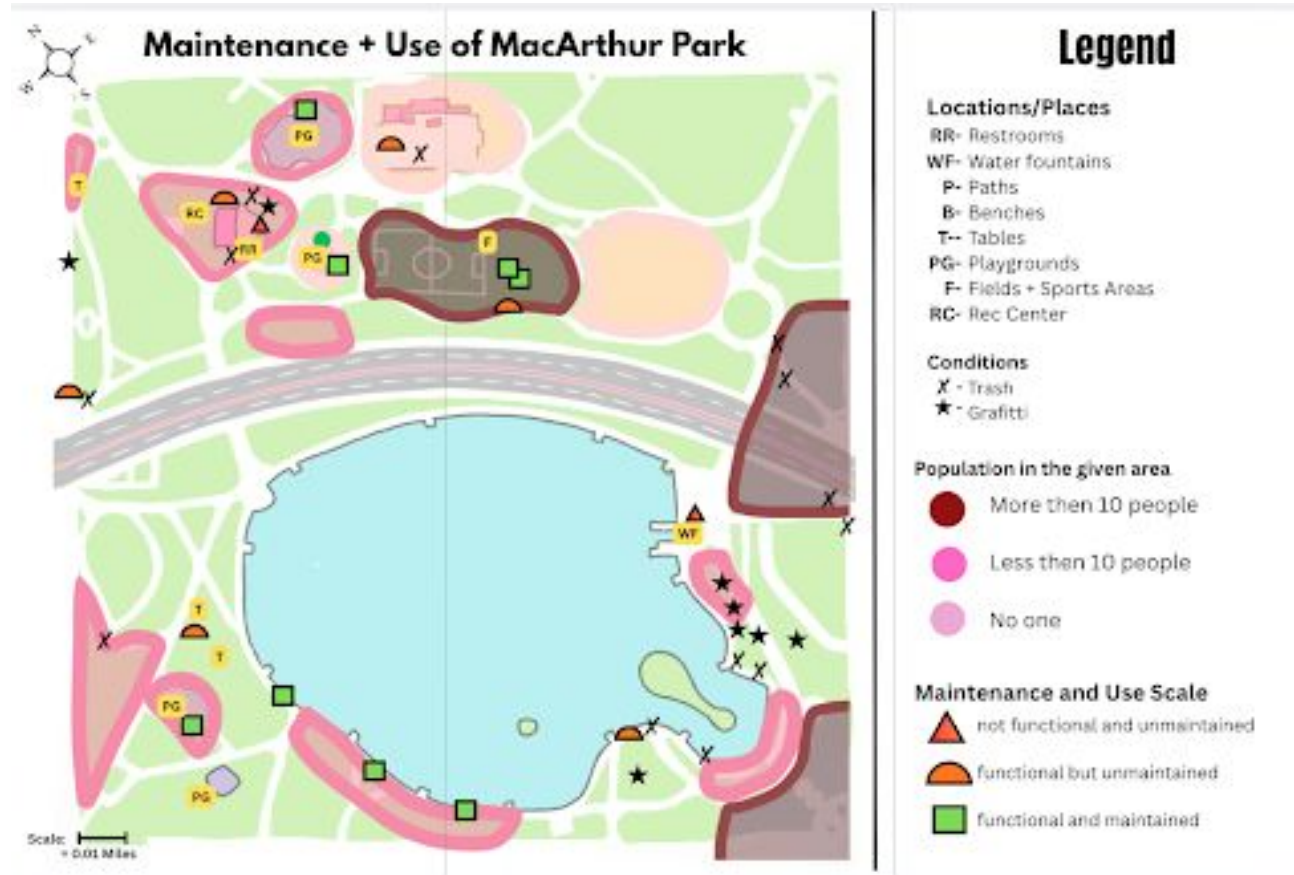

Table of Contents

Chapter One: Existing Conditions



Mapping MacArthur Park



A base map overlaid with observations from the site visit on February 18, 2025.

This map illustrates two facets of the issue of usability in MacArthur Park: population and maintenance. The blobs of pink and red denote the population in each sector of the park, with the red borders representing areas with ten or more people, the bright pink representing areas with under 10 people, and the light pink representing areas with no park patrons. The symbols represent the state of maintenance of different areas of the park – red triangle for amenities in deep disrepair, orange half-circles for areas which appear unmaintained in terms of cleanliness but are fundamentally functional, while amenities marked by green squares appear well-maintained and functional. The map aims to demonstrate the correlation (and lack thereof) between where people spend their time in the park and how well-maintained the areas are. We would have imagined before visiting the park that the amenities which were best-maintained and appeared the cleanest and newest would have been used the most, but we discovered the contrary: people tended to congregate in areas with more graffiti, trash, and amenities which appeared to be less looked-after.

From the perspective of an undergraduate and female individual, this base map consolidates perceptions of safety in MacArthur Park from two visitations. The two visitations resulted in the same distinctions, as illustrated in the map, but with two more group gatherings. Specifically, there were three religious groups along 6th Street and W 7th Street. Although these groups attracted unhoused folk and drug users with food donations, these small circles did not feel unsafe. At the same time, these circles were surrounded by green spaces dominated by unhoused individuals evidently affected by drugs. The unhoused individuals did not inflict strong senses of danger, but instead the presence of drugs and its threatening effects: aggressive behavior, insanitation, or inappropriate presentations. Mothers, their children, and young adults must've felt the same awareness as they remained distanced from this group. For this reason, there is a correlation between safe spots and family presence. Focusing more on the south segment of the park, there is a contradiction between the neutral sentiment toward the pond and its shoreline trail: trash and the possibility of falling onto the deep water.

Another base map with observations from the site visit on February 18, 2025.



Google Earth V 7.3.6.10441, (November 30, 2023), Los Angeles, CA. 34° 03' 31" N, 118° 16' 39" W, Eye alt 1786 ft. Airbus 2025, [February 18, 2026].

Narrative on Existing Conditions: *Park Politics, Users, and the Surrounding Area*

An overview of the park's current state based on insights from the engagement activity and previous two observations.



My partner and I have visited MacArthur Park twice for observation. The first time was on February 18th, around 5 p.m., when we spotted only 3 women across the park's 35 acres. In the southwest corner of the park, specifically at the intersection of W 7th St and S Park View St, sits an inclusive playground that opened in 2024. We found a middle-aged Hispanic mother with her little girl playing in the windy evening in this amenity, which was the only sighting of a parent-child duo. We later noticed another female, approximately a teenager, in the same playground with her male friends. The scarcity of present women is a notable distinction against the men who dominate the park — men being identifiable as unhoused, drug users, or general community members. There was also a small number of women affiliated with drug use or homelessness, but they were difficult to distinguish because of their drug-related instability or being clustered in groups dense with males. Our second visitation revealed similar patterns, which we will discuss in Chapter 2 of the booklet.

Based on our two observations, the combination of unhoused individuals, drug users, and people with both identifications constitutes the majority population of the park. Their presence dominates because of overdosing on the grass or benches, syringes on the floor, individuals sitting with their belongings, unsustained public art, and an insanitary public restroom. Although each woman who we interviewed perceived these attributes in their particular manner, unhoused folk and drug-users were inevitably mentioned because their strong presence impacts the experience of other women approaching the park, and how they approach it.

To construct a just public realm, as equitable designers, we must empower our target research group to reclaim their respective spaces. My partner and I are not only focusing on women, but also on the potential public art has to bring their vision of an enhanced MacArthur into life. For this reason, our research question is: How can public art at MacArthur Park be designed through and toward women's situated experiences of joy, as a practice of spatial justice?

We cannot respond to this research question or implement design intervention without accounting for the history and underlying causes of the park's current conditions. If history were to be disregarded, interventions would ultimately reproduce injustices that have deprived the Los Angeles community of a just public park. The magnitude of unhoused individuals and drug use in MacArthur Park did not suddenly manifest itself; it is an outcome of U.S. foreign policy enforcing refugee populations, redlining, concentrating them in under-resourced neighborhoods, and drug epidemics exploiting that insecurity.

Root Causes of Conditions: A Timeline

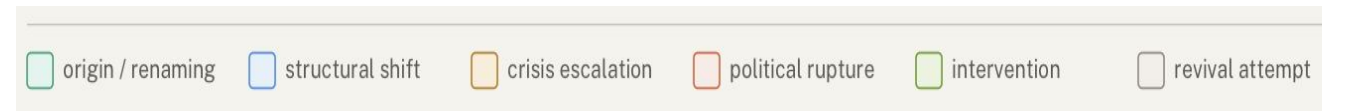

The right graphic is a historical timeline visualization synthesizing historical, social, and political dimensions that explain MacArthur Park current conditions. The above rectangle consists of different-colored boxes filtering each major event into themes.



To construct a just public realm, as equitable designers, we must empower our target research group to reclaim their respective spaces. My partner and I are not only focusing on women, but also on the potential public art has to bring their vision of an enhanced MacArthur into life. For this reason, our research question is: *How can public art at MacArthur Park be designed through and toward women's situated experiences of joy, as a practice of spatial justice?*

We cannot respond to this research question or implement design intervention without accounting for the history and underlying causes of the park's current conditions. If history were to be disregarded, interventions would ultimately reproduce injustices that have deprived the Los Angeles community of a just public park. The magnitude of unhoused individuals and drug use in MacArthur Park did not suddenly manifest itself; it is an outcome of U.S. foreign policy enforcing refugee populations, redlining, concentrating them in under-resourced neighborhoods, and drug epidemics exploiting that insecurity.

Root Causes: Redlining & Crime

MacArthur Park was constructed in the 1880s to replicate European-style public spaces, located along Wilshire Boulevard and between East and West LA. The park gathered class, culture, business, and leisure for upper-class Angelenos. This prestige altered when the 1939 Home Owners Loan Corporation (HOLC) maps — maps of U.S. major cities that color-code neighborhoods by perceived mortgage lending risk — coded Westlake primarily red (“D/Hazardous”). On the other hand, the adjacent Silver Lake neighborhood was blue. This redlining was explicitly racially based, systematically depriving colored Westlake families of loans to invest in businesses and homes.

The denial of socioeconomic mobility and local connectivity was further denied with the construction of the Harbor Freeway (I-110) and the Santa Monica Freeway (I-10) in the 1950s and 60s. These freeways lie on the edge of Pico-Union, the neighborhood south of MacArthur Park, displacing thousands of majority Latino and Black communities. Meanwhile, this same infrastructure project for a Beverly Hills Freeway was immediately killed by affluent representation. FHA-subsidized suburban homeownership — derived from redlining — and the simultaneous degradation of disinvestment and freeway disruption, empowered white flight. Collectively, these forces have embedded structural racism amongst Westlake’s majority Mexican, Central American, and Black population. A population of migrants already confronting hardship by escaping the U.S.-fueled wars and genocide, military-controlled governments, and natural disasters. For these foundational reasons, my partner and I observed mostly Hispanic and Latino individuals in the park. And some of the women we spoke to held low-paying jobs.

Westlake / MacArthur Park — Racial & Ethnic Composition

Share of total population by self-identified ethnicity, 2020 U.S. Census

Sources: LA City Census 2020 (Office of Mayor Garcetti); BestNeighborhood.org ACS 2023 estimates.

Note: 'Hispanic' is an ethnic identity; individuals may also identify with racial groups.

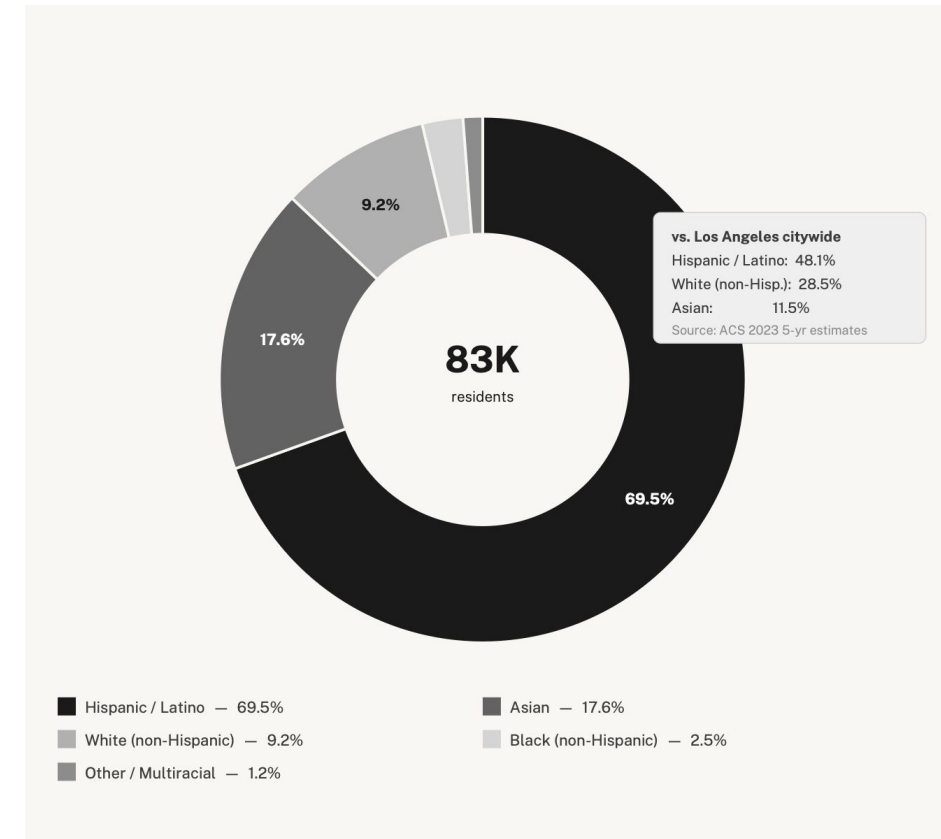

Westlake / MacArthur Park — Income & Poverty Profile

Median household income and poverty rate compared to citywide and national benchmarks

Sources: U.S. Census Bureau ACS 2023 5-Year Estimates (Point2Homes / data.census.gov); Neighborhood Data for Social Change, USC Price School (2019); LA City Planning Demographics 2023.

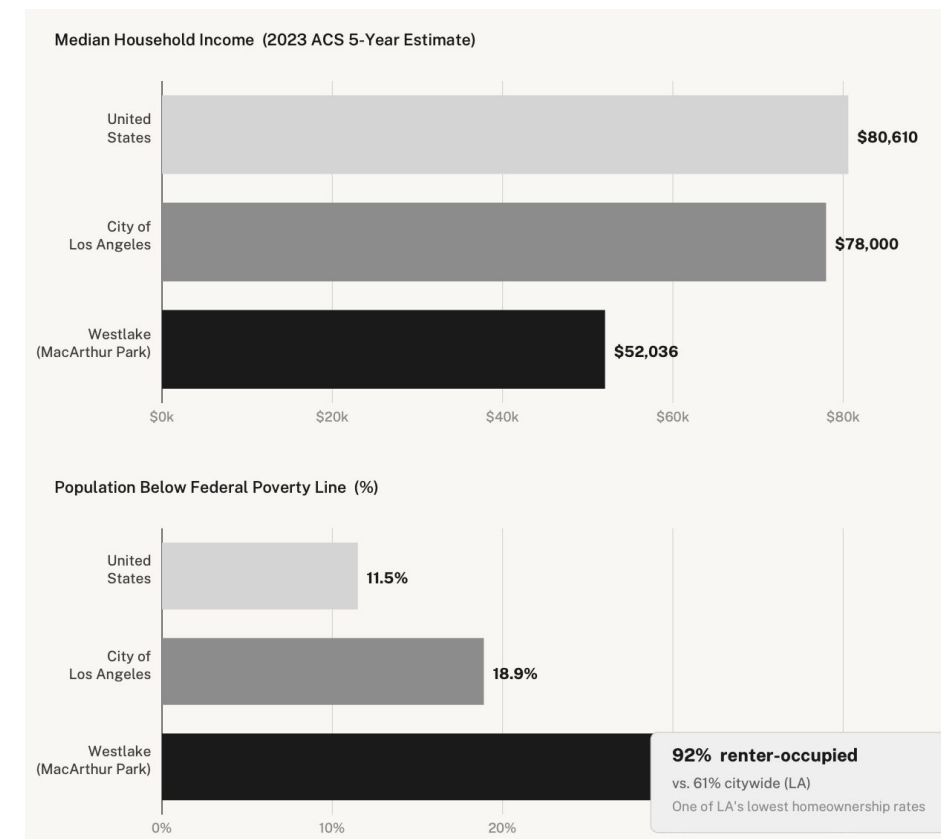

Root Causes: Crime

As the effects of white flight were increasing to their peak — an ongoing peak with systemic contributions — and Central Americans were resettling around MacArthur Park, the crack cocaine shock of the 1980s concurrently attracted dealers and users. Gangs established MacArthur as their turf, crime spilled into surrounding neighborhoods, and hence the park’s physical and reputational deterioration took off. The park transitioned its focus from a crack epicenter to fentanyl since the COVID-19 pandemic, holding some of the highest rates of fentanyl overdoses in the city. The individuals whom my partner and I witnessed — unconscious and apparently malnourished — are a direct result of the 18th Street Gang now controlling the park as a drug marketplace for years.

The image below was taken on the our visitation February 18th, a representation of the physical deterioration MacArthur Park has consistently faced. Adjacent to this spot was a mix of unhoused folk and drug users.



MacArthur Park Area — Crime Activity Trend

Violent crimes (crimes against persons) — LAPD Rampart Division, 2019–2025

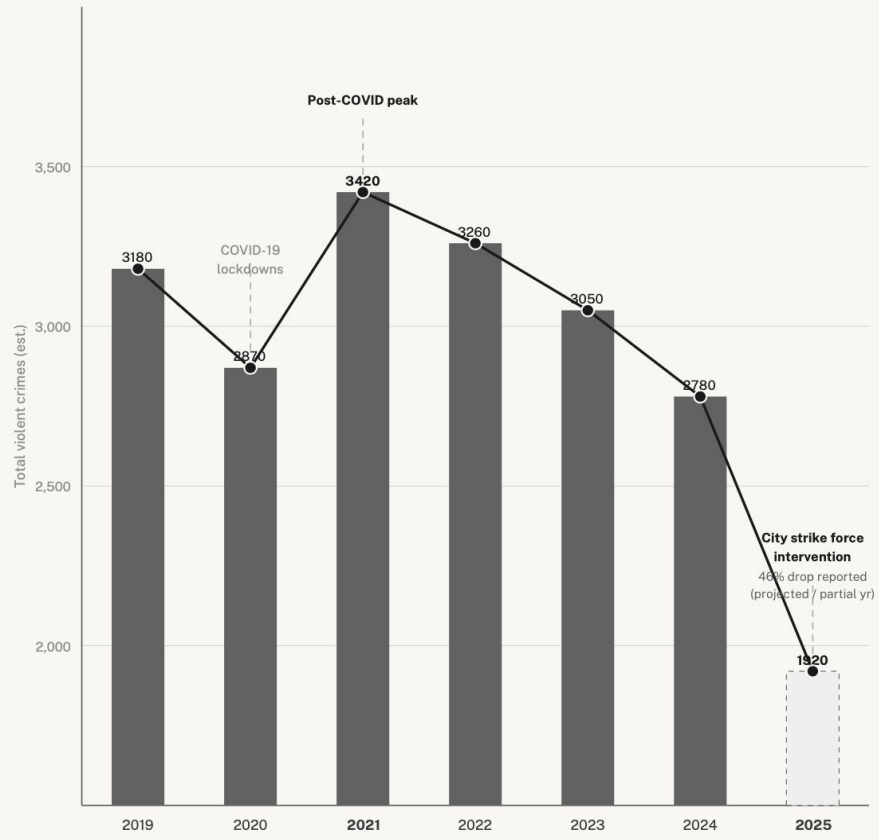

Dec 2024 26 crimes against persons / mo	Feb 2025 14 crimes against persons / mo	Change -46% in crimes against persons in 60 days
---	---	--

Sources: LAPD CompStat / Rampart Division crime reports; NBC Los Angeles (March 2025); KTLA (March 2025); CalMatters (April–May 2025). Monthly totals annualized for 2019–2024; 2025 reflects reported intervention drop.

Root Causes → Problem Statement

The image below, taken by *LA Times*, shows a man selling ice cream amongst MacArthur — representing the quietness of street vendors amidst ICE sweeps and police crackdowns.

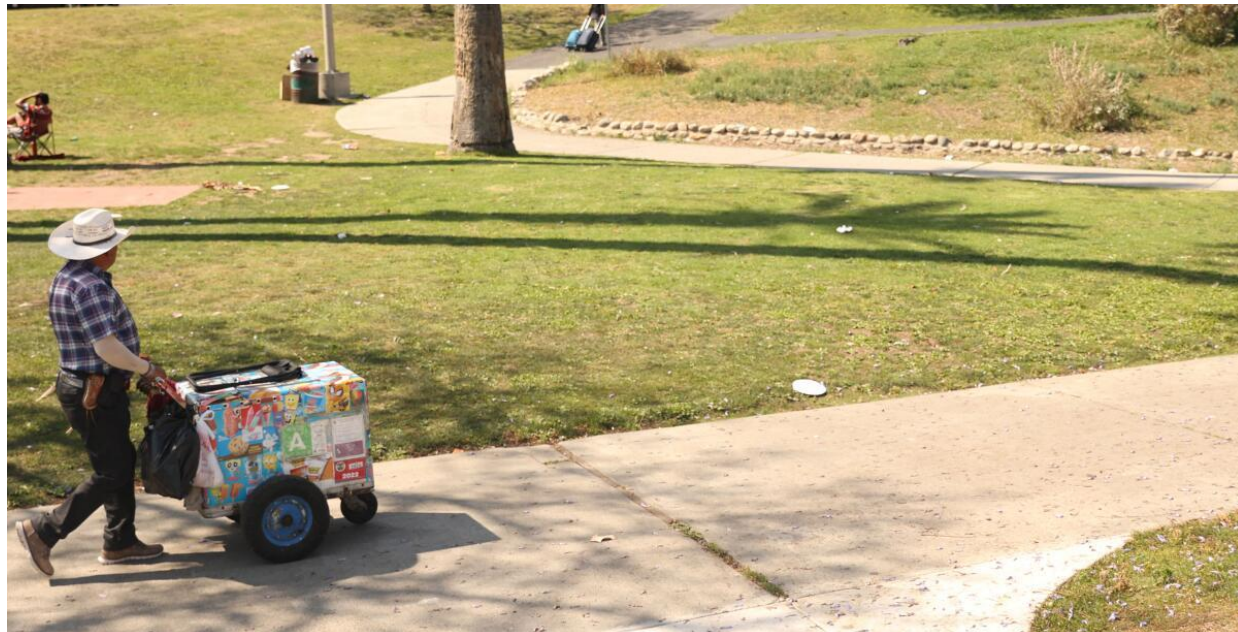

Criminal activity has attracted police enforcement over the past decades, yet this activity has become a scapegoat to justify carceral experimentation projects, racist spatial policing, and over-surveillance amongst the LAPD. LAPD's Alvarado Corridor's Initiative emphasized reclaiming public space from informal activity, like sex work and drug trafficking, but irrationally considered street vending and day labor in the crackdown. The initiative treated street vending as a barrier to the idea of a modern city, and was activated by "community input" and surveillance data that ironically falls under participatory design processes. This juxtaposition was highlighted through a middle-aged, Spanish-speaking female street vendor whom we interviewed. They expressed distrust in the capability of community engagement activities to collect authentic perspectives. Drawing on the concepts of participatory theater and fatalism in consultation, the awareness that street vendors have is reasonable. Their reality, a cultural and economic survival strategy, has been attempted to be dismantled in various ways.

A recent effort was a federal immigration operation at MacArthur Park on July 7, 2025 — roughly 100 agents, DHS helicopters, armored vehicles, and Border Patrol on horseback while children were at summer day camp and street vendors were operating. This event encapsulates the reasons for the park's current state: an immigration community seeking sanctuary yet weaponized with surveillance. The surrounding area, specifically Alvarado Street, is another example of a politically based crackdown degrading community members. The street is still enclosed with a chain link fence, inhibiting street vendors from securing income and fostering community.

With observations put forth with outlined causes, we can now arrive at an official problem statement: MacArthur Park's recurring crisis—displacement, over-policing, and the elimination of casual community life—are not random irregularities but the accumulated outcomes of redlining, disinvestment, and federal enforcement that have systematically stripped this predominantly immigrant neighborhood of its claim to a public space. For women, this dispossession is most critical: their presence in public space is rendered constantly conditional, surveyable, and revocable. A just public realm at MacArthur Park cannot be achieved through beautification or enforcement alone—it requires design that addresses the specific conditions under which women experience safety, belonging, and joy as preconditions for meaningful participation in public life.

The images below provide context from our initial park visit on February 18th, further demonstrating men's abundant presence in the park, and women's limited use.



Ch. 1 Bibliography

- Cerón, Adriana, and Mildred Montesflores. "Waves of Displacement: From Central America to Los Angeles." Migrant Roots Media, August 2, 2019.
<https://www.migranrootsmedia.org/articles/2019/8/2/waves-of-displacement-from-central-america-to-los-angeles-by-adriana-cern-and-mildred-montesflores>.
- Matthews, Joe. "Los Angeles Leaders Want to Restore MacArthur Park. Lasting Change Will Not Come Easy." CalMatters, April 30, 2025.
<https://calmatters.org/commentary/2025/04/los-angeles-restore-macarthur-park/>.
- New York Times. "MacArthur Park Immigration Raid." July 7, 2025.
<https://www.nytimes.com/2025/07/07/us/la-macarthur-park-immigration.html>.
- Villafana, Janette. "'Our Families Are Hungry:' MacArthur Park Vendors Plea to Mayor Bass to Remove Fence." L.A. Taco, March 19, 2025. <https://lataco.com/macarthur-park-fence-street-vendors-2>.
- Dunsworth, Emma. "MacArthur Park's History of Surveillance, Refusal, and Radical Care." The Metropole (Urban History Association), May 28, 2025.
<https://themetropole.blog/2025/05/28/macarthur-parks-history-of-surveillance-refusal-and-radical-care/>.
- "MacArthur Park Uncovered: 5 Surprising Truths About LA's Most Misunderstood Landmark." Insights, July 8, 2025.
https://insights.made-in-china.com/MacArthur-Park-Uncovered-5-Surprising-Truths-About-LA-s-Most-Misunderstood-Landmark_NaDGHvfbYxIM.html.
- Los Angeles City Clerk. "The Legacy of Redlining in Los Angeles: Disinvestment, Injustice, and Inefficiency." Report submitted May 6, 2019.
https://cityclerk.lacity.org/onlinedocs/2019/19-0600_misc_5-6-19.pdf.
- "Community, Politics, and Policing in MacArthur Park." eScholarship / University of California, August 2024. <https://escholarship.org/uc/item/1n22715j>.
- Katz, Jesse. *The Rent Collectors: Exploitation, Murder and Redemption in Immigrant L.A.* New York: Astra House, 2024.
- USC Health Policy Research Institute. "Unmet Health Needs for People Experiencing Unsheltered Homelessness in MacArthur Park." February 4, 2025.
https://hpri.usc.edu/social_research/unmet-health-needs-for-people-experiencing-unsheltered-homelessness-in-macarthur-park/.

Chapter Two: Community Narratives



Additional Independent Research

In this section, we will explore what existing community-facing research can tell us about women's feelings about MacArthur Park, in order to present a full body of background information.

There are a variety of behaviors and differences that women exhibit as compared to men in the park, which can inform where we focus our attention on our next site visit. Some important aspects of women's behavior include: spatial and movement behavior including perimeter-hugging and exclusive comfortability in certain areas of the park, caretaking roles, cleanliness concerns, and stroller/bus mobility burdens. A 2025 report prepared for Kounkuey Design Initiative (KDI) on MacArthur Park found that older adults face significant barriers to park access including safety concerns, limited mobility accommodations, and inadequate amenities. The study explicitly identified the need for gender-inclusive spaces as a critical design theme (Rosenbaum, A., eScholarship). Despite its flaws, the park is a "backyard" for many. As we learned in our visit to the park, many patrons see it as a space which is fundamentally unfit for families, but it is truly the outdoor space that many families have access to. It functions as a critical site for informal social services, including food and clothing distribution, religious services, and a regular meeting place for men to play cards and dice.

During our in-person visitation, we witnessed this repeated phenomena through the high usage of a man-made soccer field. Observational data revealed that men outnumber women in the park by an average of 2 to 1, and at times as much as 10 to 1. In terms of spatial and social differences, men tend to congregate in the central areas of the park, such as the soccer field and around the lake, often forming large social groups for games or exercise. Notably, women are more likely to stay near the park's perimeters, playgrounds, or service providers. They also typically appear at the park with a friend, a child, or an organization. Additionally, there are maintenance barriers: the study found that women expressed higher levels of concern regarding cleanliness and safety than men.

For example, women noted that the smells and concentrated unhoused populations on the eastern side made their experience unpleasant or led them to avoid those areas entirely. Another important aspect of women's perspectives on the park are caretaking and mobility, frequently essential duties for women. Because women are more likely to be caregivers, they face unique mobility challenges, such as navigating strollers on crowded buses or hilly terrain. The lack of storage at bus stops and child-friendly amenities makes the trip to the park more burdensome for women. Below are photos from our trip to MacArthur Park which show the congregation of men and the sparse presence of women. In particular, we observed the playground, where we might have expected to see women performing care-taking activities with kids, and there were only a few women. Contrastingly, in the sports area, there were upwards of 30 boys and men playing, talking, and generally recreating.

A UCLA study (2022) on gender-inclusive park planning in Los Angeles found that urban planning practice has created gendered environments that privilege cisgender men, and that women, nonbinary, and genderqueer people face various constraints on public space use with profound effects on health, daily living, and safety (Chu, C., 2022, eScholarship). In a study of the nearby Lafayette Park, women were underrepresented in public space and used the urban park significantly less than men. Most park users observed were men or boys. A noted potential reason for this is that women's park use tends to blend leisure with responsibility. Their most common activities include leisurely walking (often with dogs) and supervising children, while men utilized sports-centric amenities like soccer fields and skate parks. Very few women were observed engaging in strenuous physical activity or sports. The study also found that a primary barrier to park use for women is the fear of harassment or assault, particularly at night. Past experiences of being followed or cat-called elsewhere create ongoing anxiety and fear for safety in parks.

Along the same lines of interactions with strangers, women reported being "hyper-vigilant" about their clothing. In public. Some expressed choosing to wear baggy clothes specifically to avert unwanted attention or harassment while using public spaces. There are notable design features which make women feel particularly unsafe: poor lighting and overgrown shrubbery that can create "blind spots," where women feel less able to fully assess their surroundings. Additionally, the presence of trash or concentrated unhoused populations can contribute to women feeling vulnerable. In terms of the process of decision-making in planning, planning decisions are often dominated by white, middle-class, and cisgender individuals — whose voices carry disproportionate weight in municipal processes.

Traditional planning meetings often take place in the evening and exclude women who face competing responsibilities like childcare and household labor, or lack access to reliable transportation. There are a multitude of overlapping desires and priorities in public parks, and women's concerns have been historically sidelined. There is often a tension between caregiver requests and park staff practices. For example, caregivers often request exercise equipment near playgrounds so they can work out while supervising children, but park departments frequently deny these requests due to safety concerns regarding children playing on the machines.

Context Photos



To conduct our engagement activity, we visited MacArthur park on Saturday March 14th from 3:30-5 pm. It was a much livelier scene during the weekend than during our initial weekday visit, as we hypothesized. Across the park, there were hundreds of patrons, although the gender ratio was largely unchanged, with the vast majority of patrons being men. There were large groups of men especially next to the soccer field (pictured above), in the grass bordering W 6th St (pictured below), and on the corners at the intersection of Wilshire and S Alvarado St.



Below are context photos from our initial park visit on February 18th, further demonstrating men's abundant presence in the park, and women's limited use:



*Boys playing on the makeshift soccer field (above)
One woman and a child playing at the playground (below)*



Engagement Plan

A Day With the Park · MacArthur Park Community Survey

Un Día Con el Parque · Encuesta Comunitaria de MacArthur Park

We are design students researching what women need from this park. Your answers are anonymous and will help shape future design. Somos estudiantes de arquitectura investigando lo que las mujeres necesitan de este parque. Sus respuestas son anónimas.

My day now / Mi día hoy		My ideal park day / Mi día ideal en el parque	
Morning Manana		<p>North (field/rec center) - Norte (cancha/centro rec.) South (lake) - Sur (lago)</p> <p>Mark on the map where you spend time in the park. / Marque en el mapa dónde pasa tiempo en el parque.</p>	Morning Manana
Afternoon Tarde			Afternoon Tarde
Evening Tarde			Evening Tarde
<p>What brings you JOY in your life that could be brought into the park? / ¿Que le trae ALEGRÍA en su vida que puede ser introducido en el parque?</p>		<p>What would make you want to come back? ¿Qué la haría hacer regresar?</p>	

Front page of our handout for patrons

Our community engagement activity was entitled “A Day with the Park,” asking women in the park how they tend to spend their days now, and what their ideal day in MacArthur Park would look like. The initial engagement activities we designed proved too complex to realistically complete for on-the-fly interviews with women we found in the park; all of the women we talked to had activities or companions to attend to, and did not seem to have time to speak to us for more than a few minutes. Thus, we created an activity to more simply ask the questions we really wanted to know the answers to, in the pursuit of answering one central question: how can we adapt MacArthur Park to make it a place you *want* to spend your time, and a place that makes you happy? We created a handout for the women to fill out, as well as a list of prompting questions to help get ideas flowing, with a few example photos of potential park amenities. The left side of the handout asks the women to describe what their daily life looks like now, and the right side asks them to imagine how a day could be spent in the park. We wrote all of our questions and instructions in English and Spanish, to make the handouts as accessible as possible for typical patrons of the park.

In order to draft this activity, we referenced the World Bank Handbook for Gender-Inclusive Urban Planning and Design, utilizing case studies of global sites where women have been successfully incorporated into the urban planning process, leading to successful and inclusive outcomes. We found the case study of Mendoza, Argentina particularly relevant because the site has a few similarities to MacArthur Park: a highly populated area with a large public space dominated by men.

We initially wanted to explore how, why, where, and whether women feel unsafe in MacArthur Park. Yet, after even basic background research and initial observation, it is absolutely clear that women *do* feel unsafe in MacArthur Park, and it is clear why. We, as women, felt our own reservations about visiting the park alone, mostly because there were a ton of men — a few whom stared and/or approached us unsolicited. Women need community to feel safe, and MacArthur Park is quite obviously lacking a consistent community of women and families. While there is programming to support kids at the community center, and community meals to engage patrons (including a woman we spoke to) with the park, the programming is not enough to make up for the feeling of uncomfortability. We know what makes using the park harder for women: restricted mobility, fear of strange men, lack of cleanliness, and so on. Therefore, the question that we need answered by our engagement activity should be: what can we do to improve women’s experience of MacArthur Park, and simultaneously improve their lives?

Engagement Plan (continued)

Women deserve to be included in the fun part of urban planning, not just having to address the issue of safety. As our very wise professor Chelina pointed out in class, safety is a problem that women did not ask for or create, but are forced to reckon with. With all of that in mind, we wanted our interviews to not just to capture what women are afraid of or what makes them uncomfortable, but what makes them happy, what would be a beautiful thing to see in a public place. While safety is a necessary baseline in order for women to feel comfortable using the space, we imagine an ideal addition to MacArthur park could be an amenity which is functional, beautiful, and naturally increases safety as a byproduct of its existence. Ideally, rather than placing “how to deal with men” at the center of our questions, we want to ask women about themselves, and learn what matters to them. Thus, on our handout, we asked: “What brings you JOY in your life that could be brought into the park?” and “what would make you want to come back more often?”

While this research into joy sounds terrific in theory, what we quickly learned, is that any questions about the women’s personal lives, outside of their experience at the park, seemed somewhat random and tangential – when we asked about their daily routines and how they ended up at the park, the women tended to look at us slightly askew, and return to their frustrations with the lack of clean public bathrooms, the presence of unhoused folks, and the drug use. It is hard to ask people to dream big about a public space when their primary concerns are basic needs which have thus far gone unmet. We will delve into our specific findings in the next section of this booklet.

Questions we included to guide thinking on the back of our handout:

Questions to think about//preguntas para pensar en

- What’s something you use in your daily life that you could use in the park? **¿Que es una cosa que usa cada día que puede usar en el parque?**
 - Por ejemplo, maquinas de ejercicio o mesas de jardín
- What is your favorite thing about the park now? Would you like more of that? **¿Que es su parte favorito del parque ahora? Quería ver más de eso?**
 - Por ejemplo, los bancos
- Which amenity in the park is most useful to you? **¿Cuál amenidad en el parque es más útil para usted?**
 - Por ejemplo, el patio de recreo
- What is one thing that makes you happy everyday? **¿Qué es algo que le hace feliz todos los días?**
 - Por ejemplo, jardinería
- What prevents you from spending more time in MacArthur Park now? **¿Qué le impide pasar más tiempo en MacArthur Park ahora?**
 - Por ejemplo, falta de espacio limpio



Our plan for further engagement is to reach out to the leaders of the community center in MacArthur Park, and ask to attend a meeting or event, during which we can ask women participating questions about their current and ideal use of MacArthur Park. Another possibility is to collaborate with community organizations in Westlake to disperse the activity amongst more women, whether the dispersion be an online document or in-person sheet. The objective is to reach out to as many perspectives as possible to obtain accurate information.

Community Engagement Findings



We conducted our first community engagement activity in MacArthur Park on Saturday March 14th beginning at 3:30pm. It was a bustling, sunny Saturday afternoon, with lots of people lying in the grass, chatting and eating at picnic tables, and listening to music. There were many people using drugs, as well as organizations conducting religious services and providing free food to the unhoused community. Also, notably, there were lots of vendors on S. Alvarado St., contributing to the substantial foot traffic amongst the general Saturday foot traffic. The vast majority of patrons were men, and women's presence was centered in the playground, leading the religious and social services, and sparsely in the population centers near the streets. Below are photos of preparation for a religious service (top) and vending on the street (bottom).

We spoke to women in almost every section of the park: the concrete tables on the Northwest corner, the dirt next to the bathrooms, on the soccer field, on a bench near the Wilshire intersection on the East side, at a table on S Alvarado St, at a table on W 7th St, and in the grass overlooking the lake on the South side of the park. Below is a map showing the locations in which we interviewed patrons:

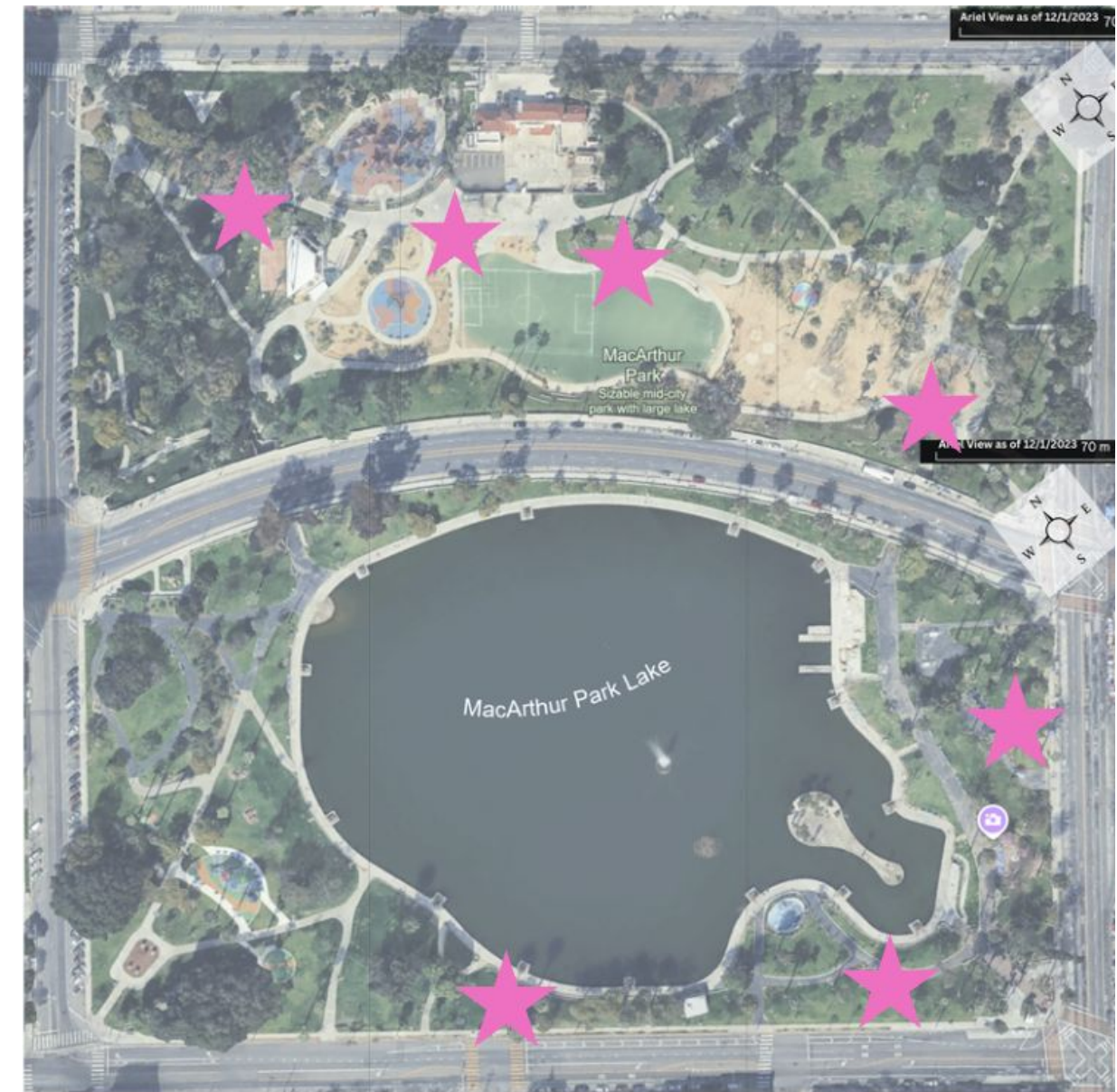

Community Engagement Findings

Ultimately, upon approaching women in the park and speaking with them, we very quickly learned how difficult it is to get people, especially strangers who are doing us a favor by speaking to us, to speak specifically about the topics we want to hear about. We spoke to nine people, and once they started talking about their feelings about the park, they all had their own direction of what they wanted to discuss. That is to say, the answers we got did not necessarily answer exactly the questions we were asking, but most people were so impassioned about what they wanted to discuss, that we listened and took notes on whatever they had to say. When the conversation reached a lull, we would ask follow-ups, often in an attempt to redirect to our questions, but our questions were likely better suited for longer conversations with individuals. Only two women told us they didn't want to talk when we approached them, everyone else was receptive to conversation.

To summarize the insight we gained from our engagement, every woman mentioned cleanliness and the presence of unhoused folks in the park as a barrier to use, with varying degrees of concern. Their age, family status, and personal ideologies also influenced their perceptions of an ideal MacArthur Park. Additionally, there is so much hopelessness surrounding the park — patron #5 in particular repeatedly stated, “this is not a place for families,” and said she would discourage any parent from bringing their child to MacArthur Park for fear of the type of behavior they would see modeled, specifically illicit drug use and public sex. This patron expressed no suggestions or desires for the future of the park, due to her lack of trust in the current patrons of the park. Additionally, there is significant distrust around people like us getting anything to change. Patron #2 said, “people come in here collecting signatures and talking about making the park better all the time and nothing ever comes of it.” Patron #2 lamented the condition of the public bathrooms, stating that nothing else needed to be dealt with until more bathrooms were added.

While we appreciated the perspective of every woman we spoke to, patron #5's perspective was particularly disheartening because she expressed the feeling that there is nothing that can be done design-wise to improve the experience of using the park as a woman. While we certainly empathize with her jadedness, considering what she has witnessed during her years of work in the park, we want to imagine a world where social services can be provided to unhoused people in the park nearby women bringing their children to the playground. The truth is, MacArthur Park is the green space that many families have access to. Another through line between interviews is that many women expressed that MacArthur Park is where they come when they need a break from their space at home — noting that their space at home feels small or cramped, and that the park provides more freedom of movement, and a break from work or homelife. Women need this park.

Overall, we encountered a wide array of contentment with the park, from a woman expressing that she had “all that she needed” by having access to a bench, to a woman expressing that she did not believe that at this point design could have any impact on the quality of the park. We spoke to women with a multitude of reasons to be in the park: mothers and a daughter, an elderly woman recreating, women working with religious organizations, and a vendor. The interventions which were repeatedly suggested based on our questions were, unsurprisingly, to add more public bathrooms, and better maintenance of trash. Additionally, the young mother we spoke to suggested a water park area for kids considering the heat in the park, as well as more comfortable seating areas so she can rest while her children play. The teenager we spoke to suggested more concert programming, stating that she had been to music events at the park before that were very fun for her.

In terms of methods, we conducted all but one conversation entirely in Spanish, so approaching the women with “¿Hola, hi, habla español o ingles?” as well as our bilingual handout was crucial. Another crucial piece of the interviewing process was taking notes for the patrons. We imagined that the women we spoke to would fill out the handout we provided, but we learned almost immediately that it is much more time-effective for the interviewees to speak while we take notes. We asked our first interviewee if she could write down a bit about her typical routine (as we had intended with the handout) and she wrote a few words and then seemed frustrated and stopped, preferring us to write for her.



On the note of how MacArthur Park integrates into the women's daily lives: patron #4 spoke about using the park as a place to sit and relax after getting off the Metro. When asked why she doesn't sit at the bus stop, she responded that there was nowhere suitable to sit. This image shows the condition of a bus stop on S Alvarado St: broken glass all over the ground amongst other trash and food.

What would a RESTFUL and ACCESSIBLE bus stop look like, where she could sit and place her shopping bags?

Chapter Three: Conclusion



Further Questions

1. What design features can make women feel more comfortable spending extended time in MacArthur Park? What are women's IDEAL USES of MacArthur Park?
2. How do INTERSECTING facets of IDENTITY change women's comfortability in MacArthur Park (age, immigration status, language, income, etc.)?
3. How can we bring JOY, MIXED USE, and HOPE to MacArthur Park with design?
4. How can we restore TRUST in the park? How can people be brought together and believe that cohabitation is possible?

Thank you for reading!